

## TECHNICAL SPECIFICATION

### Wall recessed fixtures - GRF LED007 / GRF LED008



#### Technical data

- Rated voltage: 230V / 50-60Hz
- Power:
  - GRF LED007 – 1.2W (9LEDs diam. 5)
  - GRF LED008 – 2W (16LEDs diam. 5)
- Lumens /whole fixture/:
  - GRF LED007 – 30lm
  - GRF LED008 – 35lm
- Light source: LED type diam.5mm recessed fixture
- Colour temperature: 6000-6500K
- Protection against dust and moisture : IP54
- Colour rendering index: Ra≥80
- LED driver: mounted in the body
- Switch on/off > 15 000
- Average Lifetime: 30 000h
- Operating temperature: -20° ÷ + 65°C
- Housing: stainless steel and thermoplastic combination
- Diffuser : aluminum ring and glass diffuser
- Installation: recessed outdoor ground mounting
- Surface requirements: Class F
- Protection against electric shock: I

## Areas of application

- Suitable for outdoor use
- Architectural lighting for gardens, parks , yard or other outdoor spaces

## Product benefits

- Highly efficient replacement of conventional lighting fixtures
- Low power consumption
- Repeated switch on/off does not affect the lifespan of the fixture
- Instant light with maximum luminous flux
- Environmentally friendly - no mercury and lead
- No ultraviolet and infrared rays
- Resistant to shock and vibration stable body
- Low heat emission
- Compact size

## Variants and dimensions

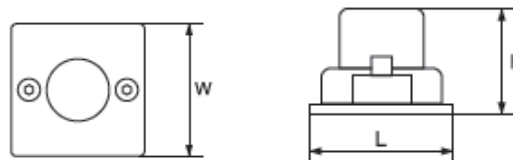

Model	LEDs (pcs)	Watt	LED chip lumens (lm)	Whole fixture lumens (lm)	Colour temp. (K)	Colour aluminum ring	Size			Catalogue number	Packing (pcs)
							L	W	H		
GRF LED007	9	1.2W	6	30	6000-6500	satin nickel	70	70	54	96GRFLED007	50
GRF LED008	16	2W	6	35	6000-6500	satin nickel	105	105	57	96GRFLED008	27

## Energy efficiency

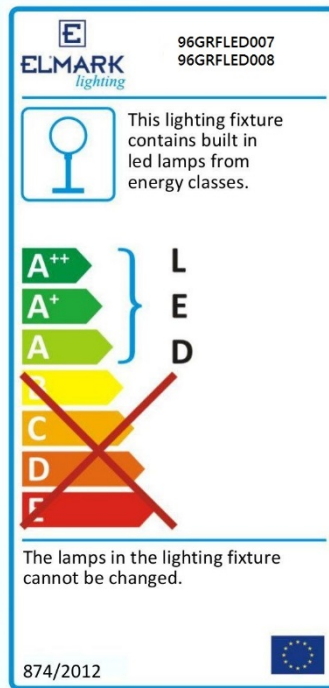

## Barcodes

Barcode	Catalogue number
3800131176059	96GRFLED007
3800131176066	96GRFLED008

## Standards

EN 55015

EN 61000-3-2

EN 61547

EN 60598-1; EN 60598-2-2

